

Clarification Responses

Please note that these measurements are approximate based on a laser distance survey of the building completed on the 5th August 2019.

Ground floor			Second floor			Height	
Point	to Point	Distance (meters)	Point	to Point	Distance (meters)	Area	Distance (meters)
A	B	17.4	GG	HH	8	1	3.6
C	D	3.9	II	JJ	4	2	3.9
E	F	8.8	II	KK	8	3	4.1
G	H	4.7	LL	MM	21.7	4	4.6
I	J	14.6	NN	OO	3.4	5	2.1
K	L	4.3	PP	QQ	3.7	6	2.9
M	N	9.6	RR	SS	3.5	7	8.5
O	P	1.7	TT	UU	14.8	8	3.6
Q	R	7.9	VV	WW	4.8	9	3.3
S	T	2.7				10	3.3
U	V	12.8	Disabled Toilet (DT)			11	5.4
W	X	23.9	Width	1.6		12	4.7
Y	X	4.8	Length	2			
AA	BB	4.8	Height	2.9			
CC	DD	4.8					
EE	FF	2.9					

Height to current suspended ceiling

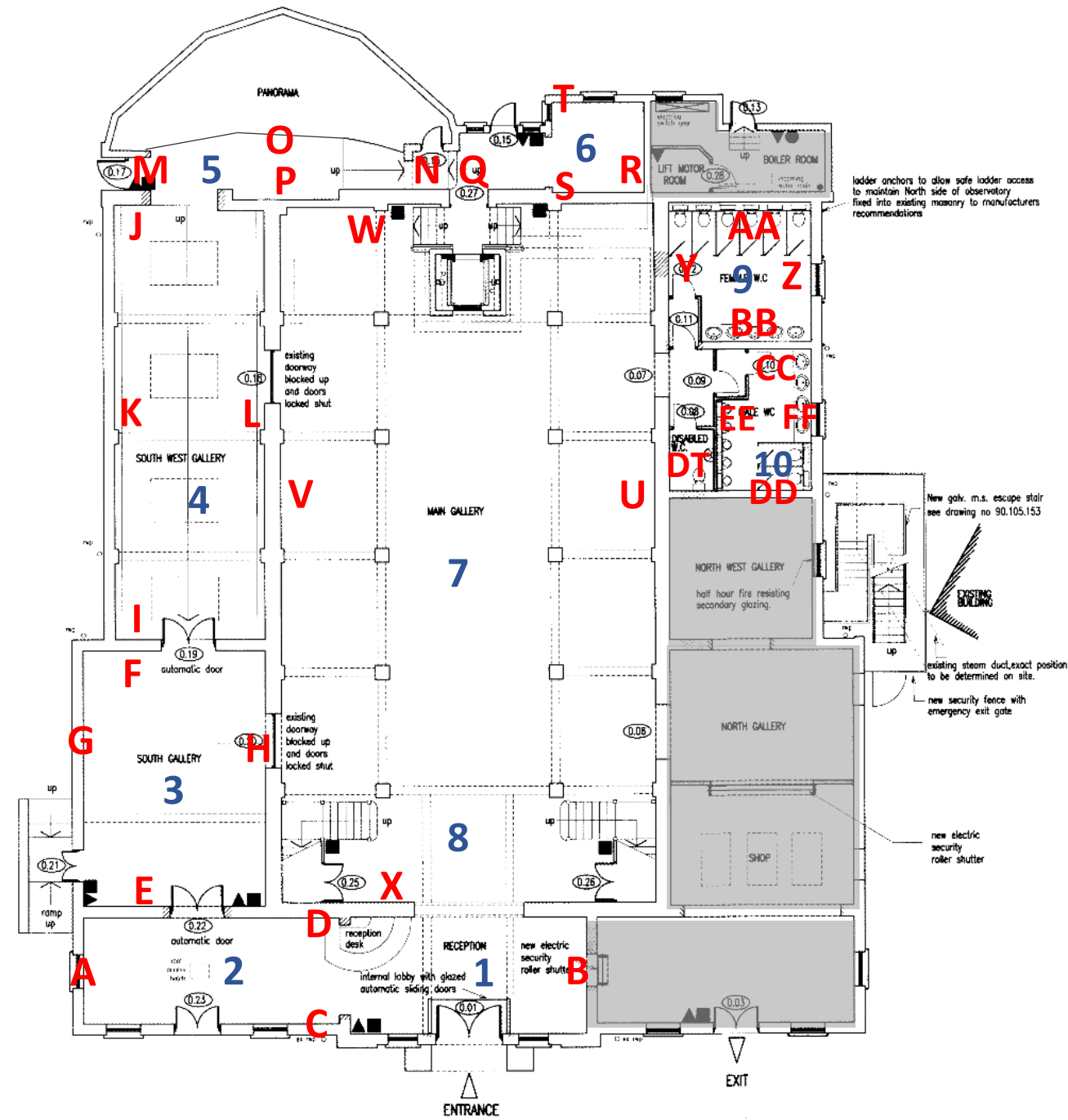

GROUND FLOOR PLAN

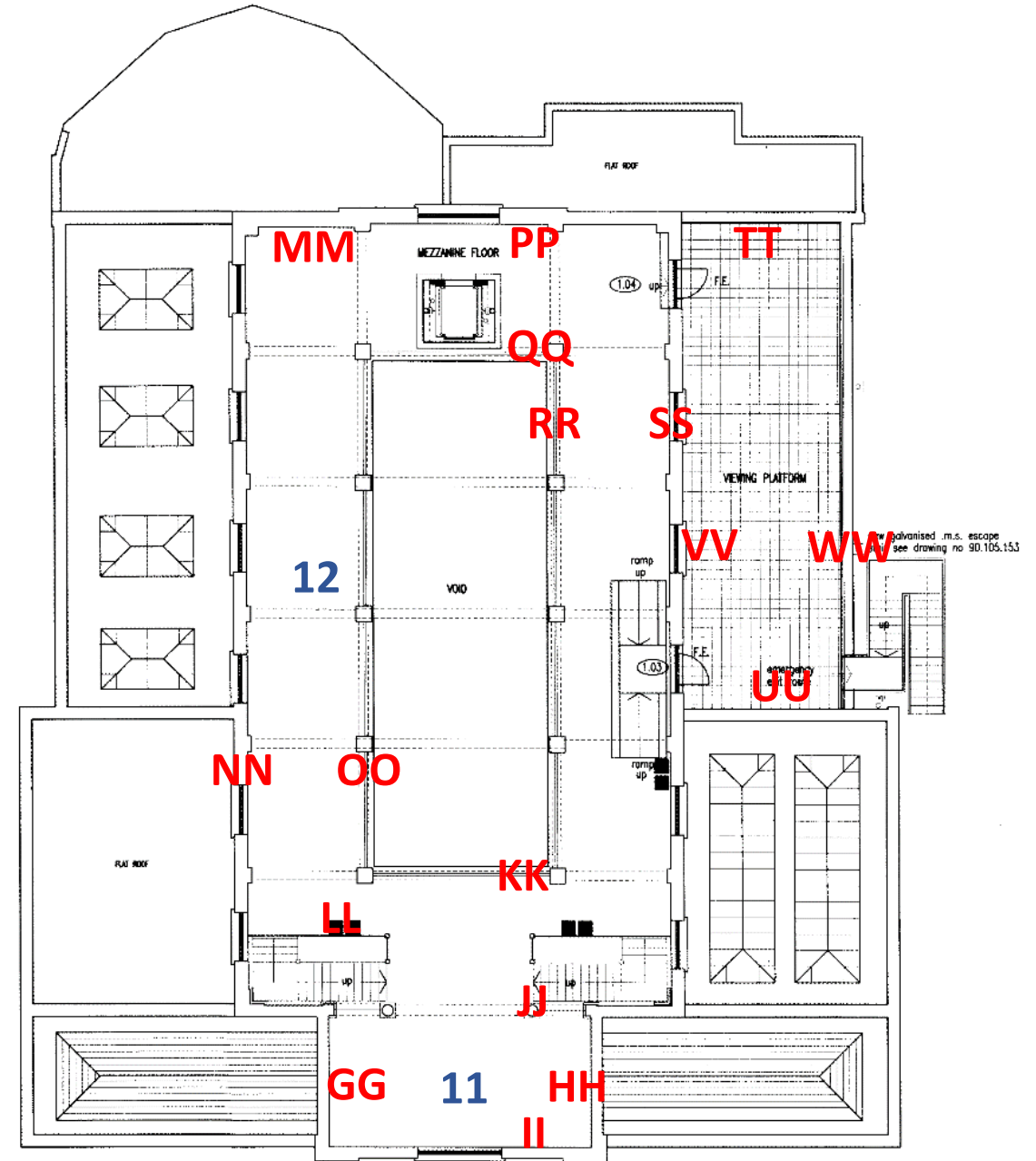

FIRST FLOOR PLAN

- KEY
- ▲ EC20 2Kg CO2 x 8
 - EH 6Ltr HYDROSRPAY(Water) x 16
 - 9Kg DRY POWDER x 1

Note:
Equipment by Chubb Fire Ltd
Tel. 0181 844 1666

Rev	Date	Description	By	FM
B	23.7.99	ISSUED FOR RECORD PURCHASE	KGM	
A	23.04.99	ISSUED FOR CONSTRUCTION	KGM	

RECORD DRAWING

HGP Greenlee Alchurch Evans Ltd.
Copyright Reserved 1999.
Do not scale - check dims. on site.

Scale: 1:100
Date: 30.3.99

Drawn by: fgh
Checked by:

ROYAL NAVAL MUSEUM
PHASE 1, PORTSMOUTH
Victory Gallery -
Fire Fighting Equipment Plans

Drawing No: 90.105.177

Grid Reference: J K L M N P O R
S T U V W X Y Z

HGP
ARCHITECTS

HGP Greenlee Alchurch Evans Limited
Forehill Farm, Wotton Road, Foreham, Portsmouth, PO19 7JH, England
Tel: 01323 283225 Fax: 01323 237004 Email: email@hgp-architects.co.uk