

FAAM Buildings (Pre Survey Information)

The museum is divided between two main sets of buildings either side of the B3151 trunk road. South of the road are the core visitor components of the museum, spread over four main halls (with a few separately located annexes).

North of the road is the storage hangar known as Cobham Hall. This state-of-the-art collection storage facility houses the museum's reserve collections.

The museum building itself is constructed from numerous hangars, many of which are in fair or poor condition.

Main Museum

Construction type - The Museum has grown as a series of steel framed add-ons around the original MOD Hangar (Hall 3 Carrier Experience). The steel frames are thought to be in good condition structurally.

Roofs – A “patch-work” of materials and construction types ranging from corrugated concrete/asbestos sheets to metal panelling. Condition is generally very poor:

- Hall 1 – Corrugated cement/asbestos. No insulation. Air pressure vents linked to gutters, which leak water and heat
- Hall 2 – Main section is corrugated cement/asbestos with no insulation. Section Adjoining Hall One was replaced in 2019, contains insulation simply covered with a rubber membrane. Installed over the previous undertray.
- Hall 3 – Generally sound. Roof replaced with metal sheeting by MOD in 1990s. Occasional leaks fixed with patching.
- Carrier Experience Chamber and Restoration hangar. Metal sheeting but lower grade than Hall 3. Roof and wall cladding exterior finish is cracking and needs refinishing/replacing.
- Hall 4 – Roof material OK but weak and safe access only achieved by scaffold system on three sides. This system has not been fitted to front gable and gutters leak despite remedial work. (the latter is due to be corrected Nov 2020).

Wall cladding – Metal sheeting with no or little insulation. Finish is failing many places:

- Hall 2 eastern “inverted White facia contains asbestos – needs resealing and painting.
- Hall 2 eastern gable end needs refinishing or replacing.
- Experience chamber and Restoration Hangar as above.
- Much of the cladding on the exterior of the building, along the west side, mainly on the exterior of Hall 3 – exterior paint layer is peeling off.

Internal construction materials - mixed

- Hall 1 – Some wall panels contain asbestos so penetrating fixings can only be used in exceptional circumstances

Other Buildings:

- Swordfish Restaurant - Refurbished 8 years ago.
- Swordfish Centre – Finish on sheet metal roof is cracking and flaking. Needs a new finish
- Concrete floors in restaurant and centre do not have Damp Proof Membranes so floor coverings bubbling and lifting.
- Workshop – WW2 Nissan hut. Well maintained, roof repainted and windows replaced recently.
- Store Room 222 – WW2 brick, concrete and metal framed hut. Concrete and asbestos roof in poor condition.
- Cobham Hall - Predominantly constructed using a steel frame and brick construction with metal sheet cladding. The roof structure is of the type common in the year of construction 1999 with the insulation values required at the time, which being a steel portal frame building with transverse purlins set at 1500mm centres supporting composite panels. The roof is generally in good order, although the gutters and downpipes have deteriorated due to a lack of maintenance in recent years and despite a short term repair, could be subject to future works.

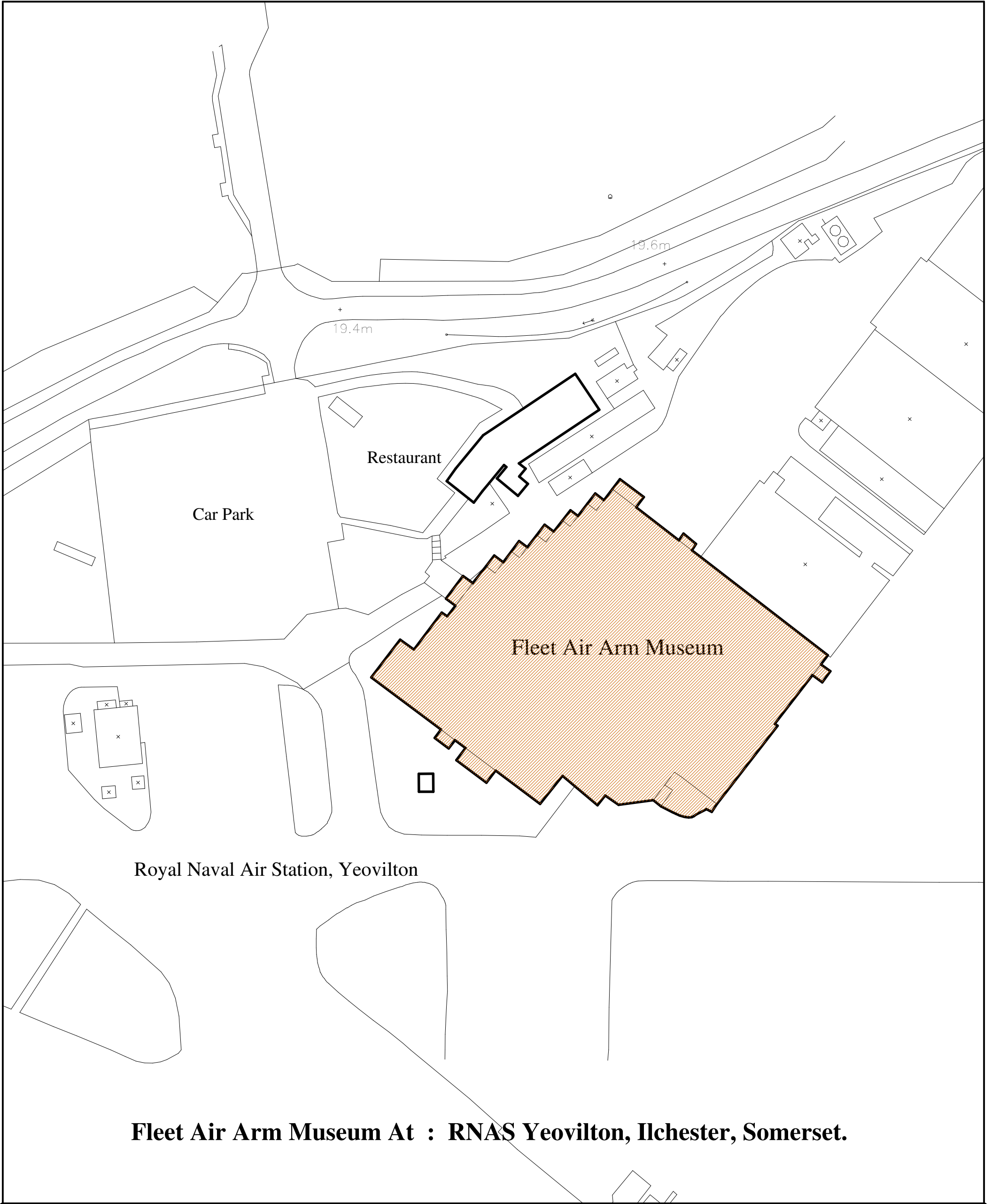

Fleet Air Arm Museum At : RNAS Yeovilton, Ilchester, Somerset.



TIMOTHY A.G. M^{AC}BEAN
 D.Arch.(Hons), Dip.Arch.Cons.R.I.B.A.
 Chartered Architect

'Georgian House'
 Greenhill
 Sherborne
 Dorset, DT9 4EP
 01935 814955

Existing Site Location Plan

SCALE :	1:1250	DWG NO :	
DRAWN :	PDR	S/2488/LP1	
DATE :	May 2017		

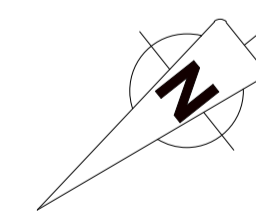
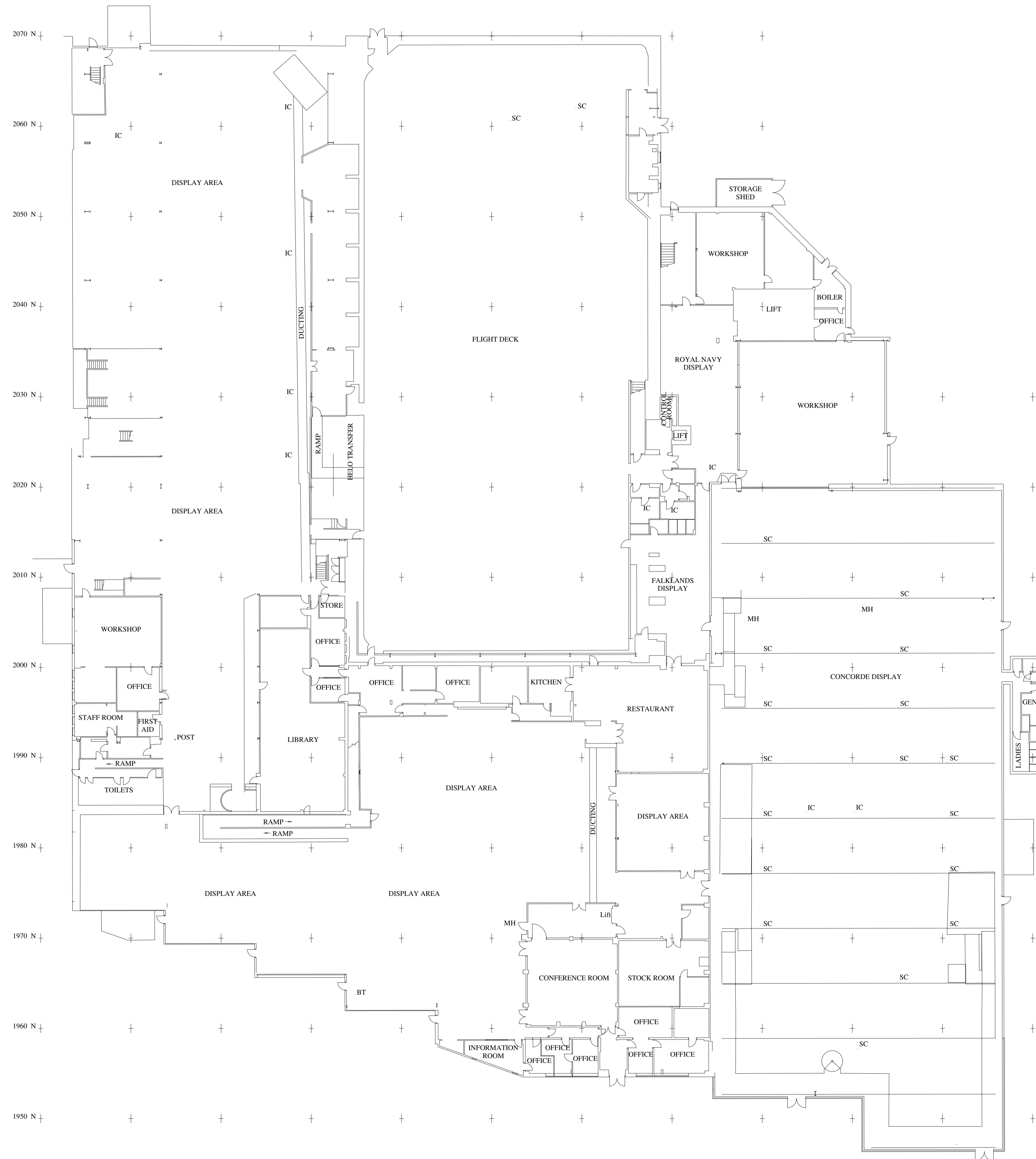

PROJECT TITLE

Updating Building Survey At : Fleet Air Arm Museum, RNAS Yeovilton, Ilchester, Somerset.



TIMOTHY A.G. MACBEAN
 D.Arch.(Hons), Dip. Arch. Cons. R.I.B.A.
 Chartered Architect

'Georgian House'
 Greenhill
 Sherborne
 Dorset, DT9 4EP
 01935 814955

Existing Ground Floor Plan

SCALE: 1:250

DWG NO:

DRAWN:

S/2488/1.0

DATE: July 2017

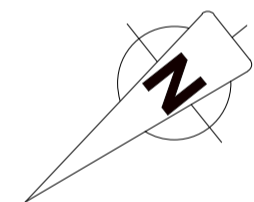
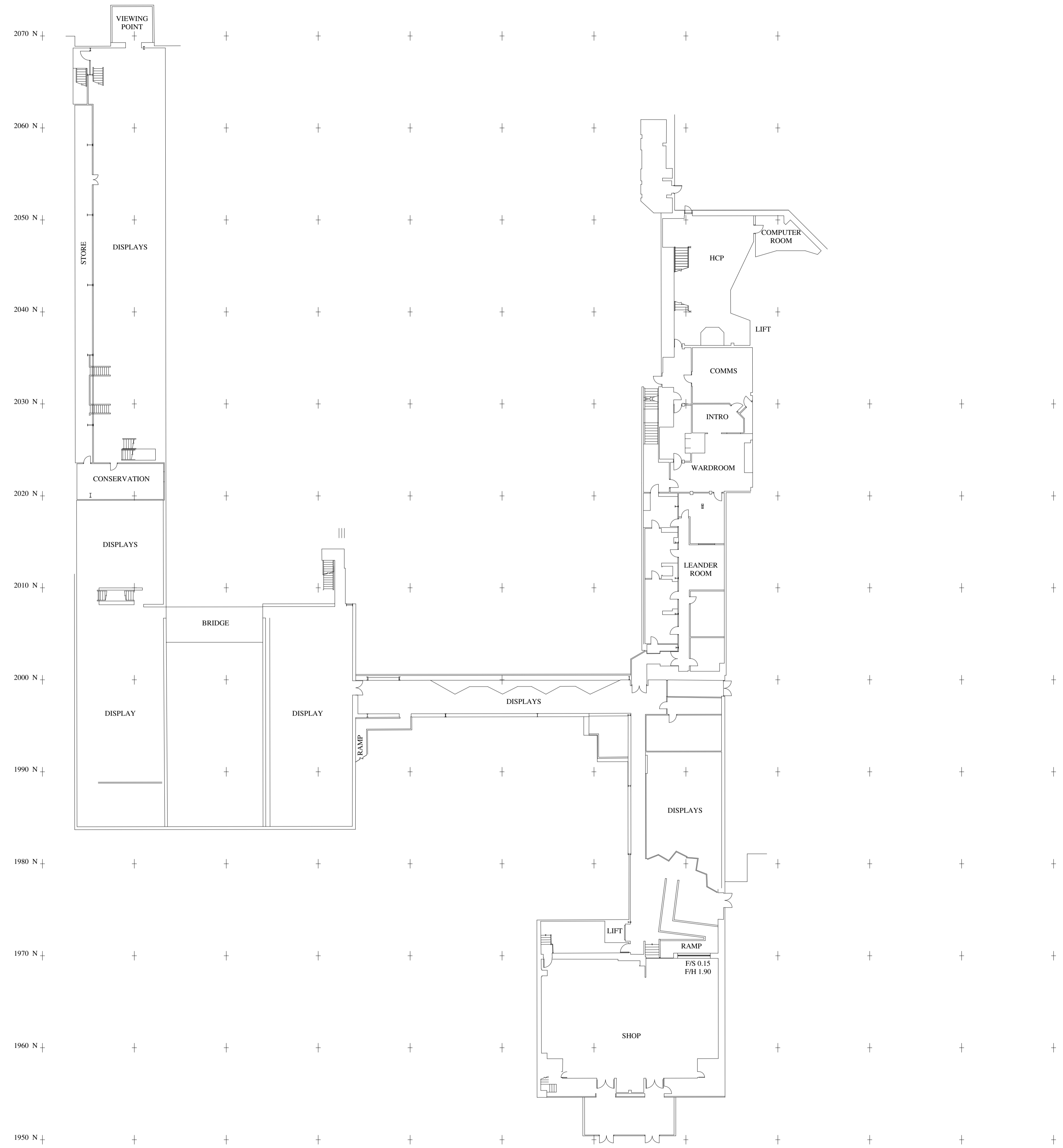

PROJECT TITLE

Updating Building Survey At : Fleet Air Arm Museum, RNAS Yeovilton, Ilchester, Somerset.



TIMOTHY A.G. MACBEAN
 D.Arch.(Hons), Dip. Arch.Cons. R.I.B.A.
 Chartered Architect

'Georgian House'
 Greenhill
 Sherborne
 Dorset, DT9 4EP
 01935 814955

Existing First Floor Plan

SCALE: 1:250

DWG NO:

DRAWN:

S/2488/2.0

DATE: July 2017